

Youth Ministries Facility
Rock Springs Baptist Church
Easley, SC

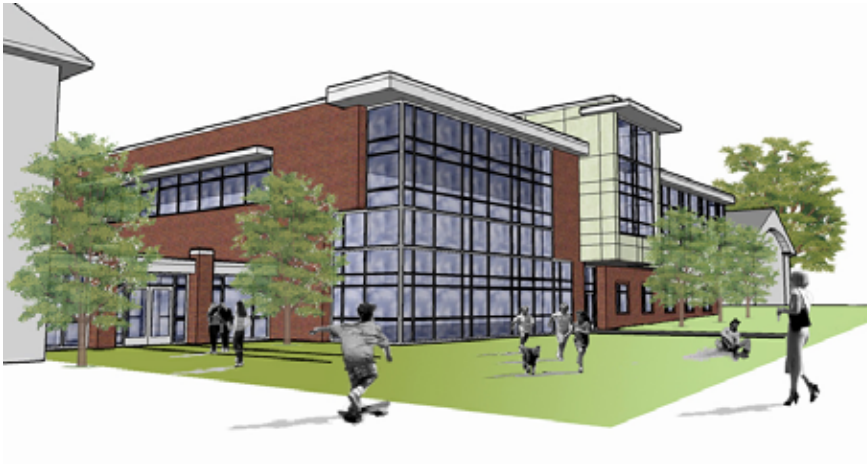

Completion:
Summer 2010

Construction Cost:
Approximately \$4.6 million

Square Footage:
36,000

Components

- Worship Spaces
- Recreation Facilities
- Offices

Separate worship spaces are planned for Middle/High School youth and for College/Young Adults.

Recreation spaces include game rooms, climbing wall, basketball shooting lane, and cafe areas.

The building will bridge between and provide handicap access to adjacent existing facilities.